



Savio Engineering, Inc.
8 Water Garden Way
Santa Fe, NM 87508 USA
<http://www.savio.cc> • email: support@savio.cc



K1002

External Pump Kit

for use with the SAVIO Skimmerfilter™

Operating Manual & Installation Guide

Read entire instructions prior to assembly and operating.



Skimmerfilters™



Livingponds Filters™



Pond Packages



Ultraviolet Clarifiers



Water Master Pumps™



Automated Water Level Sensor™



Springflo Bio Filter Media™



Greenex® Micro Granules



Aqua Flex PVC™



Black Foam



Water Treatments



Operating Capacities

The SAVio External Pump Adapter is designed specifically for use with the SAVio Skimmerfilter™. This kit allows an external pump to draw water from the Skimmerfilter's central chamber by means of a piped connection through the central baffle and external housing.

Components:



1 1/2" x 6" Pipe Nipple

1 1/2" Heavy Duty Poly Bulkhead

1 1/2" x 2" Reducing Male Adapter

K1002



Easily modify your Skimmerfilter™ to accommodate most major brands of external pumps.



[Teflon tape not included]

Tools needed:

- Teflon Tape or Pipe Thread
- Drill & Hole Saw
- Channel Locks (large)

Installation Instructions

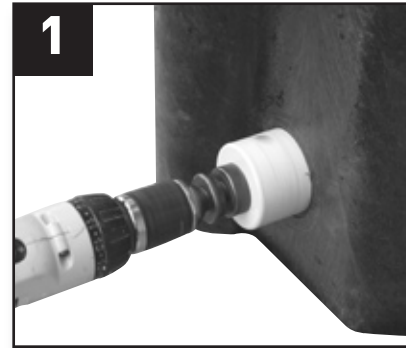

1 Drill a 2-5/8" hole in lower housing of the Skimmerfilter™ for bulkhead fitting. Use existing marks for placement.

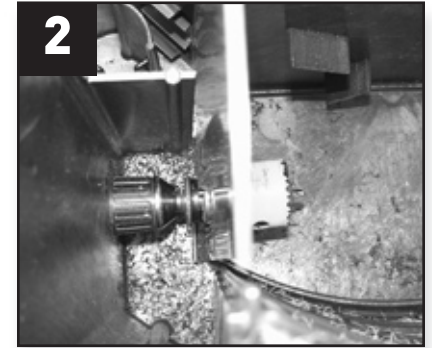

2 Drill 1-7/8" hole in inner baffle shield.



3 Insert bulkhead. Attach bulkhead with locknut on the outside of Skimmerfilter™ and tighten with channel locks.



4 Apply teflon tape to outer threads of male adapter and insert into bulkhead

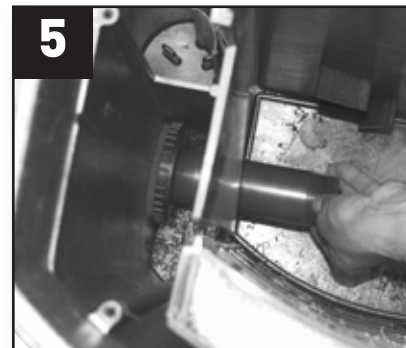

5 Insert the pipe nipple into the bulkhead fitting from inside the Skimmerfilter™ chamber. Hand tighten.



6 An external pump may now be connected to male adapter using PVC.